



## Polly in the Air

### Learning values

- Exploring airborne devices
- Investigating security at take off and landing
- Describing scenery from a birds eye view

### Recommended materials

- 9335 Space & Airport Set

### Vocabulary

Encourage the use of these words during the activity:

- Airborne device
- Kite
- Aeroplane
- Propeller
- Safety
- Landscape
- Take off
- Landing
- Runway

### Connect

Polly is an outdoor person and she loves all sorts of outdoor activities. Lately, she has taken an interest in flying devices such as kites and aeroplanes.

While watching her beautiful kites drift in the air, she has often wondered what it would feel like if she could fly.

Although her dream to 'Fly like a Bird' isn't possible, she wonders what it would be like to fly a propeller plane and drift away while watching life on earth far below. How cool would that be?



Use the illustration to support the Connect story

## Construct

- Design and make a small propeller aeroplane that can fulfil Polly's dream of flying.



Suggested model solution

## Contemplate

- Ask the children to explain how they can be sure that the propeller works.
- Discuss what actions can be taken so a small aeroplane can fly safely.
- Have the children describe what Polly sees from the aeroplane: Landscapes, houses, cars, animals in the fields, etc.

## Continue

- For Polly, the risky part of flying is taking off and landing. Help her by designing and making a runway that will help her navigate both at take off and landing.
- Polly has friends asking if they can come with her on a flight. She would like to but her plane is only built for one person. Can you rebuild the plane so it seats both Polly as the pilot and a friend as passenger?

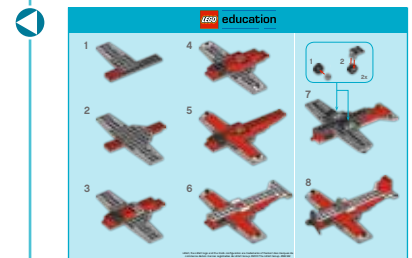

Can be used as inspiration



